

Ramsey Inc.

Certified Wildlife Biologist
State-Federal Wetland Jurisdictions
Hazardous Materials Management
Nuisance Exotic Plant Management
Prescribed Burn Manager

E-mail: Ramsey.Inc@embarqmail.com
Office: 239.564.1660
2631 4th St. NW, Naples, FL 34120

04 November 2024

James Schulze
665 93rd Ave N
Naples, FL 34108

Street Address: 1493 Rock Rd. ;Rural Fringe Mixed Use District, Neutral
City: Naples ; State: FL; County: Collier;
Sec 32 TwN 48 Rge 27; Road Frontage: NONE, Unrestricted Access Esmtfeet
; Acres: 1.25
Initial Evaluation

PROJECT: PID 00221920008 ;

This letter is in response to your request for a review of the project property as described above (Figures 1 and 2) per the rules of the Florida Department of Environmental Protection (DEP), the South Florida Water Management District (SFWMD), and/or the U.S. Army Corps of Engineers (USACOE) Section 404 of the Clean Water Act (CWA) for the presence of jurisdictional wetlands and/or surface waters and the need for permits. **DEP administers determination of Jurisdictional Wetlands for both the DEP/SFWMD and USACOE Section 404.**

To determine if jurisdictional wetlands are present 3 components (soils, vegetation, and hydrology) of a property are investigated. If any 2 of the components reveal wetland characteristics then, DEP/SFWMD claims jurisdictional wetlands for the State of Florida. If all 3 components have wetland characteristics then the USACOE claims jurisdictional wetlands at the Federal level. Depending on the situation permits could be required from DEP/SFWMD and USACOE prior to the commencement of any type of clearing or construction activity in jurisdictional wetlands.

SOILS. The soils are mapped by the Natural Resource Conservation Service (NRCS) for Collier Co. The soils present are #18 Riviera (H), and #21 Boca. The #18 soil is considered to be a wetland soil type by NRCS (Figure 3). Soil sampling onsite **did not** reveal wetland characteristics in the 425 area.

VEGETATION. The vegetation on the property is defined by the Florida Land Use, Cover and Forms Classification System (FLUCFCS, Figure 4,5,6) as:

425 Temperate Hardwoods/ DEP-SFWMD,USACOE Not Jurisdictional 1.14 acres;

HYDROLOGY. Last, for DEP/SFWMD there **were not** indications of hydrology on the property. For USACOE, there **were not** indications of hydrology on the property.

CONCLUSION. This review of the property indicates that there **are no jurisdictional wetlands on the property.**

Construction of a single-family residence on this parcel **will not require** an Environmental Resource Permit (ERP) from DEP/SFWMD for State of Florida jurisdictional wetlands and/or surface waters if any part of the 425 area is impacted. It **will not require** a USACOE permit for impacts to jurisdictional wetlands, and a review for impacts to Protected Species.

This evaluation is invalid if more than 1 year since the date on the Wetlands Determination Field Work Sheet. The property needs to be revisited to note any changes.

Please call if you have any questions.

Best regards

Michael R. Ramsey
President

ADDITIONAL INFORMATION.

- A; Agriculture
- This property is also located in the Rural Fringe Mixed Use Overlay (RFMUO) of Collier County (Figure 11). This parcel is classified as NEUTRAL and has additional building restrictions. More information is available at <https://www.colliercountyfl.gov/government/growth-management/divisions/planning-and-zoning-division/comprehensive-planning-section/rural-fringe-mixed-use-district/tdr-program-rural-fringe-mixed-use-district> . This is the web site for Collier Co.'s Transfer of Development Rights (TDR) program and the additional building restrictions on properties in the RFMUO area.
 - 1 house per 5 acres or less, if non conforming
 - No Guest House
 - Accessory Structures allowed
 - NEUTRAL: 60% preservation of existing protected vegetation, not to exceed 45% of parcel total area.
- This property has received the new Flood Zone classification of AH. Zone AH requires mandatory flood insurance for homes financed. The estimated 100 year base flood elevation is between 13.5-14.5 NAVD.
- This lot has 50 foot front & back setbacks, and side setbacks of 16.5 feet; it is considered a “non-conventional lot.”
- This lot cannot be subdivided.
- A borrow pit for fill can be excavated on this lot.
- ACCESS: The Access Esmt and Rock Rd is an Unrestricted Access Easement. Each landowner is responsible for the 30 feet of the property within the easement. The road is not maintained by Collier Co. Government.

PROJECT LOCATION MAP

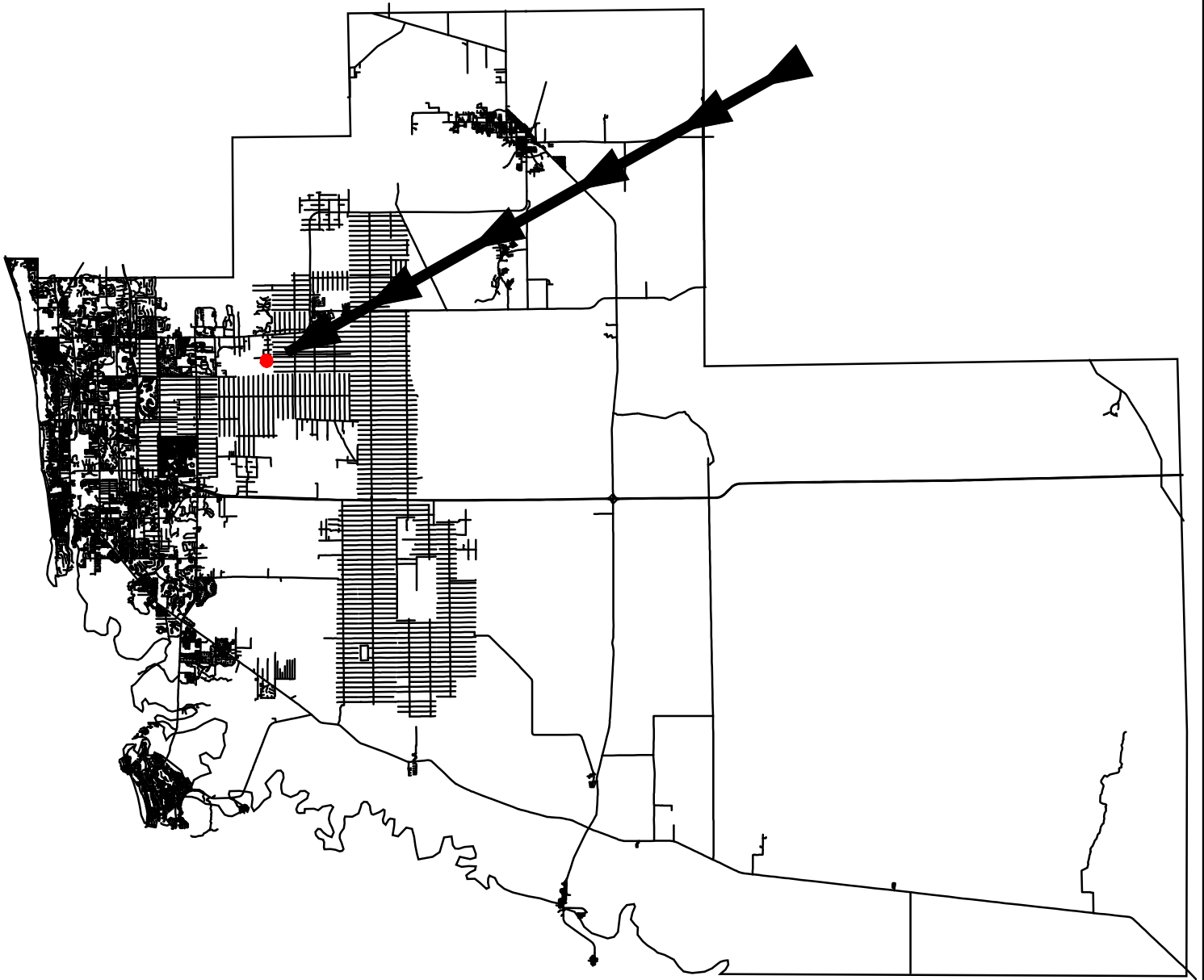

PROJECT: SCHULZE, JAMES PID 00221920008
1493 ROCK RD , COLLIER CO, NAPLES, FL

Figure 1. Project Location Map.

1493 Rock Rd, Collier Co, Naples, FL
Sec 32 ; Twn 48 ; Rge 27 ; totaling 1.25 acres
PID 00221920008

RAMSEY INC.

Environmental Consulting
2631 4th St. NW
Naples FL, 34120
239.564.1660
Ramsey.Inc@embarqmail.com

PROJECT LOCATION DETAIL MAP

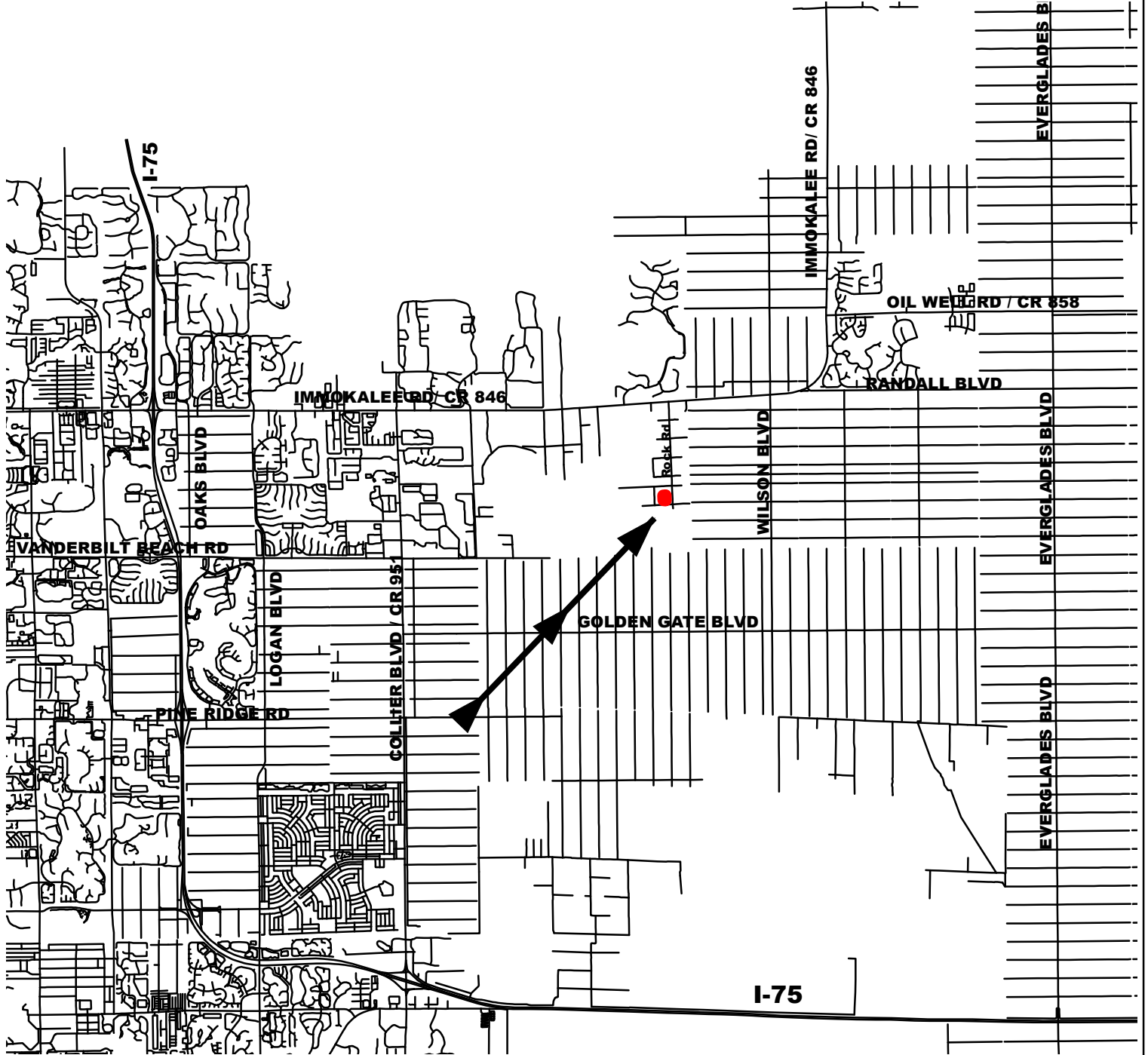

PROJECT: SCHULZE, JAMES PID 00221920008
1493 ROCK RD , COLLIER CO, NAPLES, FL

Figure 2. Project Location Detail Map.

1493 Rock Rd, Collier Co, Naples, FL
Sec 32 ; Twn 48 ; Rge 27 ; totaling 1.25 acres
PID 00221920008

RAMSEY INC.

Environmental Consulting
2631 4th St. NW
Naples FL, 34120
239.564.1660
Ramsey.Inc@embarqmail.com

SOIL MAP



#21 BOCA

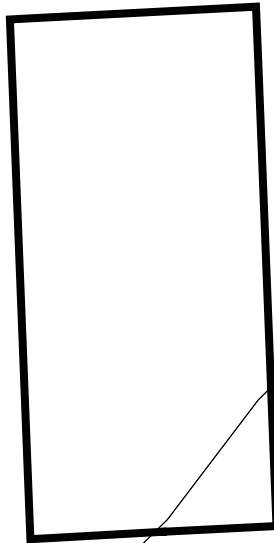

#18 RIVIERA (H)

**PROJECT: SCHULZE, JAMES PID 00221920008
1493 ROCK RD , COLLIER CO,NAPLES,FL**

Figure 3. Soil Map

RAMSEY INC.

Environmental Consulting
2631 4th St. NW
Naples FL, 34120
239.564.1660
Ramsey.Inc@embarqmail.com

1493 Rock Rd, Collier Co, Naples, FL
Sec 32 ; Twn 48 ; Rge 27 ; totaling 1.25 acres
PID 00221920008

FLUCFCS / VEGETATION MAP

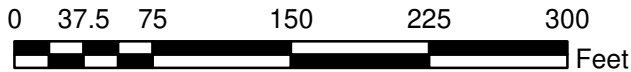
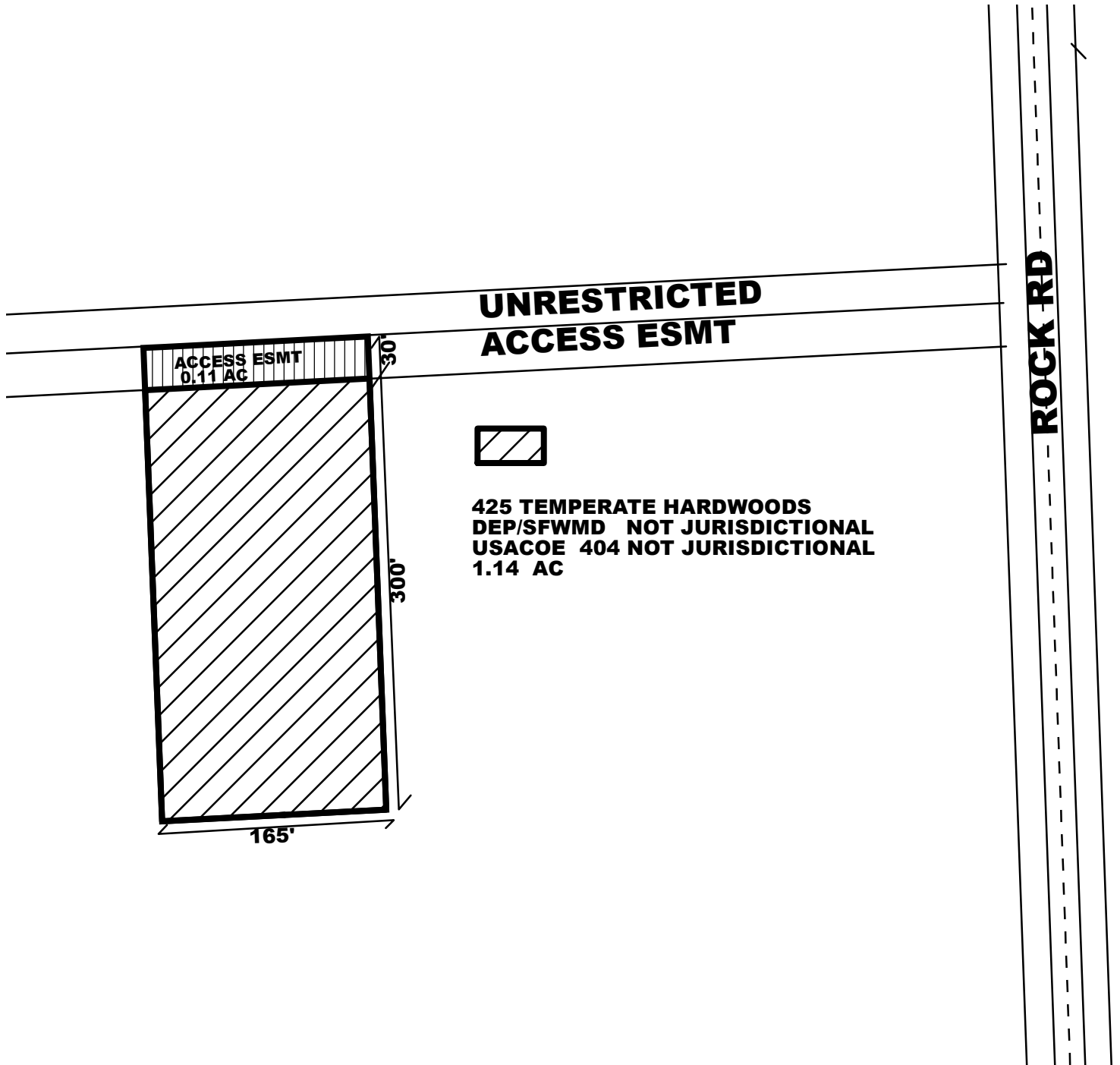

**PROJECT: SCHULZE, JAMES PID 00221920008
1493 ROCK RD , COLLIER CO, NAPLES, FL**

Figure 4. FLUCFCS / Vegetation Map.

RAMSEY INC.

Environmental Consulting
2631 4th St. NW
Naples FL, 34120
239.564.1660
Ramsey.Inc@embarqmail.com

1493 Rock Rd, Collier Co, Naples, FL
Sec 32 ; Twn 48 ; Rge 27 ; totaling 1.25 acres
PID 00221920008

AERIAL / FLUCFCS / VEGETATION MAP

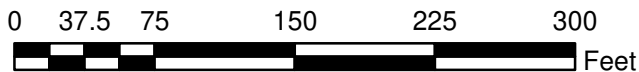

PROJECT: SCHULZE, JAMES PID 00221920008
1493 ROCK RD , COLLIER CO, NAPLES, FL

Figure 5. Aerial / FLUCFCS / Vegetation Map.

1493 Rock Rd, Collier Co, Naples, FL
Sec 32 ; Twn 48 ; Rge 27 ; totaling 1.25 acres
PID 00221920008

RAMSEY INC.

Environmental Consulting
2631 4th St. NW
Naples FL, 34120
239.564.1660
Ramsey.Inc@embarqmail.com

ZOOM OUT AERIAL MAP



**PROJECT: SCHULZE, JAMES PID 00221920008
1493 ROCK RD , COLLIER CO, NAPLES, FL**

Figure 6. Zoom Out Aerial Map.

1493 Rock Rd, Collier Co, Naples, FL
Sec 32 ; Twn 48 ; Rge 27 ; totaling 1.25 acres
PID 00221920008

RAMSEY INC.

Environmental Consulting
2631 4th St. NW
Naples FL, 34120
239.564.1660
Ramsey.Inc@embarqmail.com

DFIRM MAP

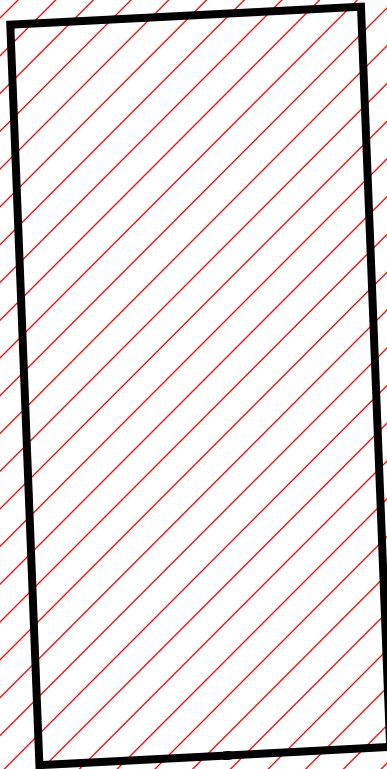

Legend DFIRM ZONES



PARCEL



AH_ZONE 13.5-14.5 FT NAVD

**PROJECT: SCHULZE, JAMES PID 00221920008
1493 ROCK RD , COLLIER CO,NAPLES,FL**

Figure 10. Digital Flood Rate Insurance Map.

1493 Rock Rd, Collier Co, Naples, FL
Sec 32 ; Twn 48 ; Rge 27 ; totaling 1.25 acres
PID 00221920008

RAMSEY INC.

Environmental Consulting
2631 4th St. NW
Naples FL, 34120
239.564.1660
Ramsey.Inc@embarqmail.com

RURAL FRINGE MIXED USE DISTRICT-TDR CLASSES

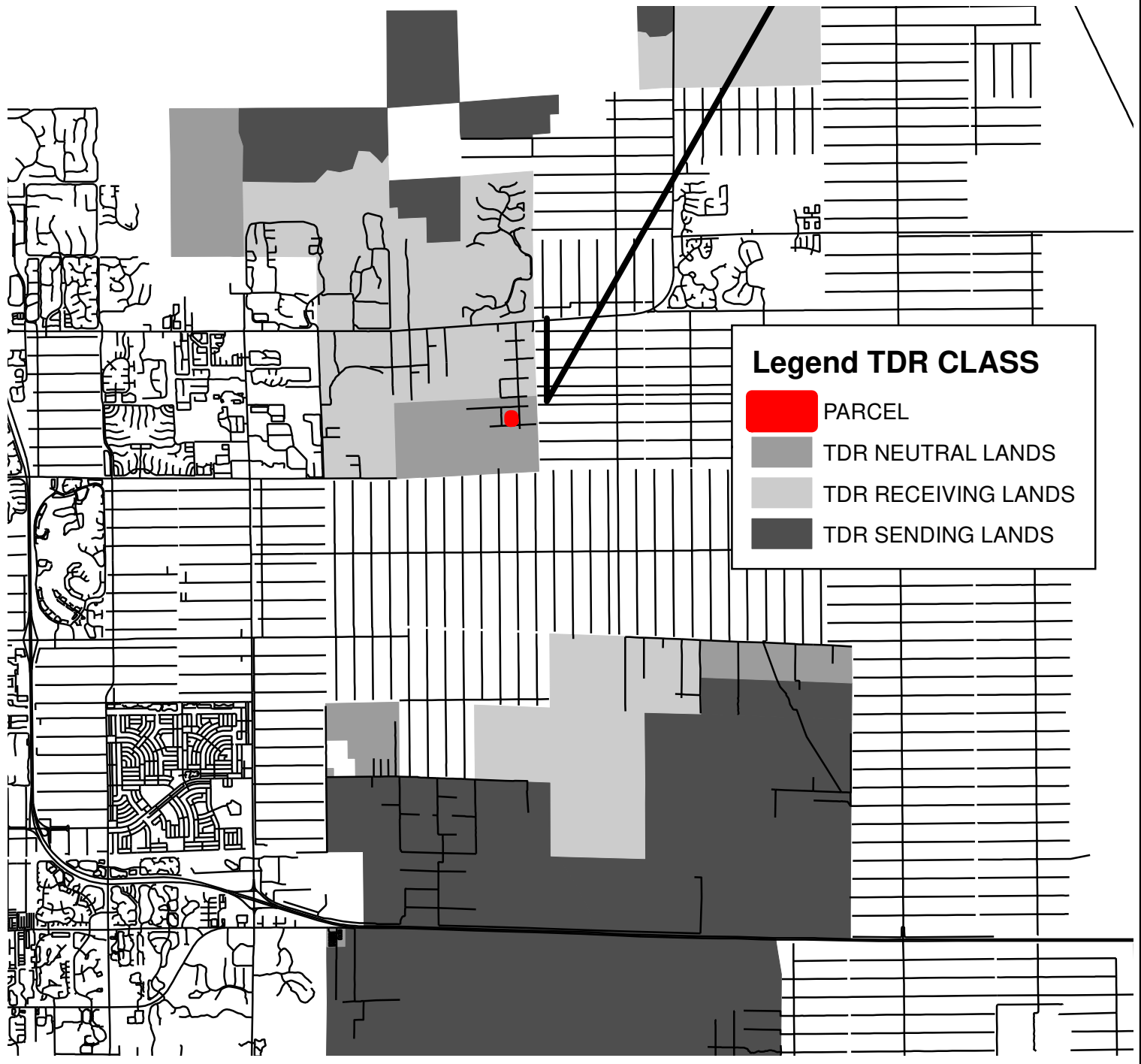

Legend TDR CLASS

- PARCEL
- TDR NEUTRAL LANDS
- TDR RECEIVING LANDS
- TDR SENDING LANDS

**PROJECT: SCHULZE, JAMES PID 00221920008
1493 ROCK RD , COLLIER CO,NAPLES,FL**

Figure 11. Rural Fringe Mixed Use-TDR Classes

1493 Rock Rd, Collier Co, Naples, FL
Sec 32 ; Twn 48 ; Rge 27 ; totaling 1.25 acres
PID 00221920008

RAMSEY INC.
Environmental Consulting
2631 4th St. NW
Naples FL, 34120
239.564.1660
Ramsey.Inc@embarqmail.com

SITE PHOTOS

425



PROJECT: SCHULZE, JAMES PID 00221920008
1493 ROCK RD , COLLIER CO, NAPLES, FL

Figure 12. Site Photos

1493 Rock Rd, Collier Co, Naples, FL
Sec 32 ; Twn 48 ; Rge 27 ; totaling 1.25 acres
PID 00221920008

RAMSEY INC.

Environmental Consulting
2631 4th St. NW
Naples FL, 34120
239.564.1660
Ramsey.Inc@embarqmail.com

DEP/WMD WETLANDS DETERMINATION FIELD WORK SHEET

Date: 10.30.24

Processor: MICHAEL R. RAMSEY, RAMSEY INC

CLIENT: SCHULZE, JAMES

MAP FLUCCS CODE: 425 TEMPERATE HARDWOODS

PROPERTY LEGAL: PID 00221920008

1493 ROCK RD 32 48 27 1.25 AC

DITCHES: DITCHES ARE A SPECIAL CATEGORY FOR THE DEP. THEY ARE NOT WETLANDS, BUT ARE JURISDICTIONAL BECAUSE THEY ARE DUG INTO THE GROUND AND HAVE NO OTHER PERMITS ACTIVE CONCERNING THEIR OPERATION OR FUNCTION. DITCHES ARE JURISDICTIONAL BECAUSE THEY AFFECT SURFACE WATERS, SIDE SLOPES ARE 4:1 (H:V) OR STEEPER AND ARE MEASURED FROM TOP OF BANK TO TOP OF BANK

DITCHES PRESENT: YES NO SEE FIG 4 N/A XX YES NO FUNCTIONAL N/A XX YES NO JURISDICTIONAL: SURFACE WATER

VEGETATION:		WETLAND	YES	NO	XX	INDICATOR STRATA: CHARACTERIZING VEGETATION HAS TO BE 10% OR MORE OF AERIAL COVERAGE	
N/A	% FAC		5-10	%	FAC W	0	% OBL
50-60	% SABAL PALMETTO(F)				QUERCUS LAURIFOLIA(FW)		TAXODIUM DISTICHUM(O)
	% MYRICA CERIFERA(F)				ACER RUBRUM(FW)		PERSEA PALUSTRIS (BORBONEA) (O)
	% SCHINUS TEREBINTHIFOLIUS(F)				CELTIS LAEVIGATA		ILEX CASSINE (O)
	% MELALEUCA QUINQUENERVIA(F)						SALIX CAROLIANA(O)
	% ACACIA AURICULIFORMES(F)				Other		FRAXINUS CAROLINIANA(O)
							Other

SUBCANOPY		WETLAND	YES	NO	XX	INDICATOR STRATA: CHARACTERIZING VEGETATION HAS TO BE 10% OR MORE OF AERIAL COVERAGE	
N/A	% FAC		5-10	%	FAC W	0	% OBL
20-30	% SABAL PALMETTO(F)				QUERCUS LAURIFOLIA(FW)		TAXODIUM DISTICHUM(O)
	% MYRICA CERIFERA(F)				ACER RUBRUM(FW)		PERSEA PALUSTRIS (BORBONEA) (O)
10-20	% SCHINUS TEREBINTHIFOLIUS(F)				CELTIS LAEVIGATA		ILEX CASSINE (O)
	% MELALEUCA QUINQUENERVIA(F)				CORNUS FOEMINA (F)		SALIX CAROLIANA(O)
	% FICUS AUREA(F)						FRAXINUS CAROLINIANA(O)
	% DIOSPYROS VIRGINIANA (F)				Other		CEPHALANTHUS OCCIDENTALIS (O)
	% EUGENIA CUMINI (F)						Other
	% ACACIA AURICULIFORMES(F)						Other

Other Other Other Other

GROUND COVER		WETLAND	YES	NO	XX	INDICATOR STRATA: CHARACTERIZING VEGETATION HAS TO BE 10% OR MORE OF AERIAL COVERAGE	
N/A	% FAC		5-10	%	FAC W	0	% OBL
20-30	% SABAL PALMETTO(F)				QUERCUS LAURIFOLIA(FW)		TAXODIUM DISTICHUM(O)
	% MYRICA CERIFERA(F)				ACER RUBRUM(FW)		PERSEA PALUSTRIS (BORBONEA) (O)
20-30	% SCHINUS TEREBINTHIFOLIUS(F)				CORNUS FOEMINA (F)		ILEX CASSINE (O)
	% MELALEUCA QUINQUENERVIA(F)				AMPHICARPUM MUHLBERGIANUM (FW)		SALIX CAROLIANA(O)
	% FICUS AUREA(F)				BLECHNUM SERRULATUM(FW)		FRAXINUS CAROLINIANA(O)
	% DIOSPYROS VIRGINIANA (F)				CENTELLA ASIATICA (FW)		CEPHALANTHUS OCCIDENTALIS (O)
	% EUGENIA CUMINI (F)				CHRYSOBALANUS ICACO (FW)		ANNONA GLABRA (O)
	% ACACIA AURICULIFORMES(F)				CIRSILIUM NUTTALLI (FW)		BACOPA (O)
	% ANDROPOGON VIRGINICUS(F)				COMMELINA SP (FW)		CLADIUM JAMAICENSE(O)
	% ARISTIDA STRICTA(F)				CONOCARPUS ERECTUS (FW)		DICHROMENA LATIFOLIA (O)
	% AXONOPUS SP (F)				COREOPSIS SP (FW)		ELEOCHARIS SP (O)
	% BACCHARIS HALMIFOLIA(F)				CYPERUS LIGULARIS(FW)		ERIOCAULON SP(PIPEWORTS) (O)FW
10-20	% BIDENS PILOSA (F)				CYPERUS ODORATUS(FW)		FUIRENA SCIRPODEA(O)
	% BUMBELIA (F)				DICHROMENA COLORATA (FW)		JUNCUS SP.(O)
	% DIGITARIA SEROTINA(F)				DIODIA VIRGINIANA (FW)		LUDWIGIA SP (O)
	% DIOSCOREA BULBIFERA (F?)				EUSTACHYS GLAUCA (FW)		LYTHRUM SP (O)
	% ERAGROSTIS SP (F)				FIMBRISTYLIS ANNUA (FW)		NYMPHAEA SP (O)
	% ERIGERON QUERCIFOLIUS (F)				GLEDITSIA TRIACANTHOS (FW)		MUHLENBERGIA CAPILLARIS (O)
	% ERYNGIUM BALDWINII (F)				HELIANTHUS SP (FW)		PANICUM HEMITOMON (O)
	% EUPATORIUM SP (F)				HYDROCOTYLE SP (FW)		POLYGONUM SP(O)
	% EUTHAMIA SP (F)				HYPERICUM SP (FW)		PONTEDERIA CORDATA (O)
	% FIMBRISTYLIS SPATHACEA(F)				HYPTIS ALATA (FW)		PROSERPINACA SP (O)
	% FORESTIERA SEGREGATA(F)				JUNCUS MARGINATUS (FW)		RHYNCHOSPORA (O)
	% ILEX OPACA V OPACA(F)				LACHNOCAULON SP(BOGUTTON)(O)FW		SAGITTARIA LANCIFOLIA (O)
	% IMPERATA CYLINDRICA (F? COGON)				LINDERNIA GRANDIFLORA (FW)		SETARIA MAGNA (O)
	% LACHNANTHES CAROLIANA(F)				MELANTHERA HASTATA (FW)		THALIA GENICULATA (O)
	% MELCOHIA CORCHORIFOLIA (F)				PANICUM REPENS (FW)		TYPHA SP (O)
	% MIKANIA SCANDENS (F)				PASPALUM LIGULARIS (FW)		
	% PHYLA SP (F)				PLUCHEA SP (FW)		
10-20	% PSYCHOTRIA SP.(F)				RHEXIA SP (FW)		
	% RUBUS SP (F)				RUMEX VERTICILLATUS (FW)		
	% SAMBUCUS CANADENSIS (F)				SCLERIA SP (FW)		
	% SESBANIA SP (F)				SOLIDAGO (FW)		
	% SETERIA GENICULATA (F)				SPARTINA BAKERI (FW)		
5-10	% SMILAX SP (F)				THELYPTERIS SP (FW) SHELD FERN		
5-10	% TOXICODENDRON RADICANS(F)				WOODWARDIA VIRGINICA (FW) V CHN FERN		
5-10	% VITIS ROTUNDIFOLIA(F)				XYRIS CAROLINIANA (FW)		
	% WEDELIA TROBATA						

Other Other Other Other

HYDROLOGIC INDICATORS:		YES	NO	XX	SURFACE WATER PRESENT	
	MUCK SOIL PRESENT					AQUATIC PLANTS
	ALGAL MATS				AQUATIC MOSSES/LIVERWORTS	BUMMELING
	WATER MARKS				DRIFT LINES	HYDROLOGIC DATA
	AUFWUCHS				VEGETATED TUSsocks/HUMMOCKS	SEDIMENT DEPOSITION
	RAFTING OF DEBRIS				ELEVATED LICHEN LINES	AQUATIC FAUNA

SOILS: HYDRIC INDICATORS:		YES	NO	XX	SOIL DESCRIPTIONS: 10YR	
	Indicators:					Depth "
	A8 Muck Presence	YES	NO	XX	layer of muck w value 3 or less chroma 1 or less win 6" surface	0.0-6.0 A 3/1 SAND
	F5 Thick Dark Surface	YES	NO	XX	layer at least 6" thick with a depleted matrix that has 60% more chroma 2 or less starting below 12" of surface	6.0-9.0 A2 5/1 SAND
	F10 Marl	YES	NO	XX	layer of marl w value of 5 or more starting win 4" of surface	9.0-12.0 E 7/2 SAND
	A4 Hydrogen sulfide odor	YES	NO	XX	within 30 cm surface	
	A5 Stratified Layers	YES	NO	XX	starting win upper 6"; 1 or more layers has value >3 with chroma 1 or >; and/or it is muck	
	A6 Organic Bodies	YES	NO	XX	2% or more .5-1" muck/muck mineral texture within 6" surface	0.0-7.5 A 3/2 SAND
	A7 5cm Mucky Mineral	YES	NO	XX	2" layer within 6" of the surface	7.5-8.0 A2 6/1 SAND
	S4 Sandy Gleyed Matrix	YES	NO	XX	gleyed matrix which occupies 60% or more of a layer win 6in of the surface	8.0-12.0 A3 5/2 SAND
	S5 Sandy Redox	YES	NO	XX	layer win 6 in of surface that is at least 4 in thick & has matrix w 60% or more in chroma 2	
	S6 Stripped Matrix	YES	NO	XX	stripped areas over .5"-1" in diam; 10% of area	
	S7 Dark surface	YES	NO	XX	layer at least 4" thick starting win 6" of surface w value 3 or less & chrom 1 or less; 70% particles covered by organic material	
	F2 Loam Gleyed Matrix	YES	NO	XX	gleyed matrix which occupies 60% or more of a layer starting win 12" of the surface	
	F3 Depleted Matrix	YES	NO	XX	layer at least 6" thick w/depleted matrix that has 60% or more chroma 2 or less starting win 10" of surface	
	F13 Umbritic surfaces	YES	NO	XX	on concave positions of interstream divides & depressions; layer 6" thick starting win upper 6"; w/value 3 or less & chroma 1 or less	
	DEP/SFWM	A-test: YES	NO	XX	AREAL EXTENT OBL > UPL; hydric soils; hydrology	
		B-test: YES	NO	XX	AREAL EXTENT OBL & FACW >= 80% UPLAND (excluding FAC)	
		C-test: YES	NO	XX	MUCK SOILS	
		D-test: YES	NO	XX	Hydrology and hydric soils	
	Altered Site	YES	NO	XX		

If claiming Wetlands based on Reasonable Scientific Judgement, provide evidence below:

SOIL TYPE:
#21 BOCA
#18 RIVIERA (H)

WETLAND:		STATE OF FL: DEP, SFWM	
JURISDICTIONAL DETERMINATION	IF YES-JURISDICTIONAL:	ISOLATED	CONNECTED
	YES	NO	N/A XX
	NO	NO	N/A XX

SURFACE WATER:		EXOTIC INFESTATION LEVELS	
JURISDICTIONAL DETERMINATION	YES	NO	N/XX
	YES	NO	N/XX

NOTE: IF DITCHES ARE PRESENT AND ARE NON-FUNCTIONAL--NO MITIGATION IS REQUIRED.

ADDITIONAL INFO:

E0 - 0% AREAL COVERAGE
E1 - 1%-25% AREAL COVERAGE
XX E2 - 26%-50% AREAL COVERAGE
E3 - 51%-75% AREAL COVERAGE
E4 - 76%-100% AREAL COVERAGE